

Roller Blind Systems





Motorised Roller Blind System

Silent Gliss® 4960

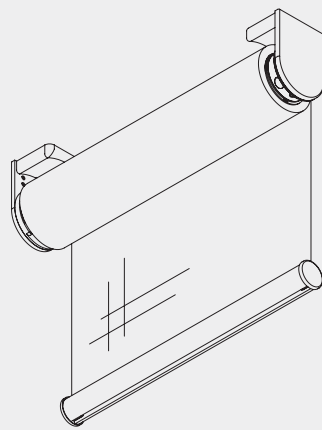

Product Information

- Medium duty motorised roller blind system for contract and residential applications
- Fixed switch or optional radio remote control
- The system can be used as a single or connected double system with one motor
- Progressive limit switch unit for easy setting and consistent positioning
- Easy ceiling, wall or recess fix
- Optional continuous installation profile with click in brackets for fast fixing on site
- Side-by-side/double version with centre support bracket and minimal light gap
- Side guide option available
- Choice of bottom bar designs
- Optional metal design brackets with or without continuous headrail
- Quiet and fast mains powered motor
- Optional 24V DC motor available
- Can be combined with Radio Remote Control System Silent Gliss 9940/0450



4960

Profile and Specification Information

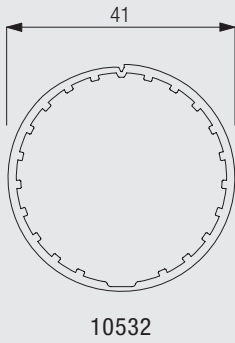

Specification Guide - download from the Silent Gliss Website (password required) www.silentgliss.co.uk

Electrically operated roller blind system 4960. Assembled complete with anodised aluminium headrail and 10542/10543 bracket set for wall or ceiling fixing. White bracket covers 10574 and 10575 supplied as standard. Double (connected) system option using bracket 10626 or side-by-side (unconnected) system using intermediate cover 10632. White/silver aluminium bottom weight bar 4221 with endcovers 10639 as standard (other shape options available). Powered by 230V 50Hz double insulated motor situated left side incorporating a progressive limit switch unit (24V DC motor option also available). Provided with in-line connector 0766 as standard.

How to Measure

Single system

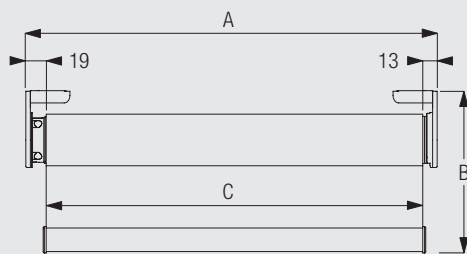

A: system width (inside recess includes bracket covers)
 B: system drop
 C: fabric width

Please note:

- OUTSIDE recess does not include bracket covers, please add 4mm.
- measurements differ when side-guide option is used.



4960

Double (connected) systems (only possible with 230V motors) - not available with design bracket option

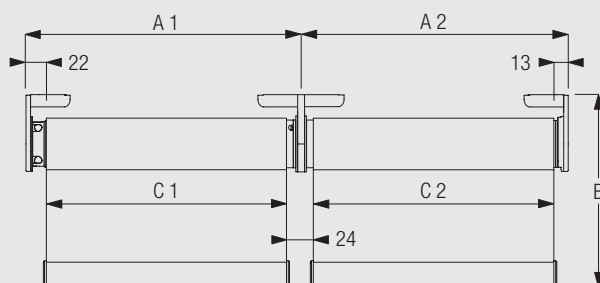

A: system width (inside recess includes bracket covers)
 B: system drop
 C: fabric width

Please note:

- OUTSIDE recess does not include bracket covers, please add 4mm.
- measurements differ when side-guide option is used.

Side-by-side systems (unconnected)

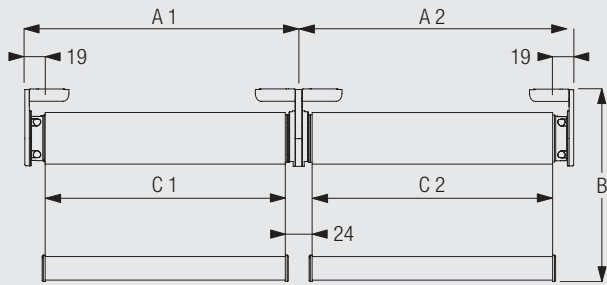

A: system width (inside recess includes bracket covers)
 B: system drop
 C: fabric width

Please note:

- OUTSIDE recess does not include bracket covers, please add 4mm.
- measurements differ when side-guide option is used.

System Dimensions



Single system: 2.4m
 Double System
 (connected) with 230V
 motor only: 4.8m

Motor 230V: 61cm
 Motor 24V DC 50cm

4m

Single system: 9.6m²
 Double system 19.2m²

5.5kg

Maximum system width to drop ratio should not exceed 3.5:1

Please note: maximum system width/drop also depends on the fabric type.

Maximum system drop

Wall fitting:

Fabric thickness	mm	0.15	0.20	0.25	0.30	0.35	0.40	0.45	0.50	0.55	0.60	0.65	0.70	0.75	0.80
Max. system drop	cm	400	400	400	400	400	400	390	350	320	290	270	250	230	220

Ceiling fitting:

Fabric thickness	mm	0.15	0.20	0.25	0.30	0.35	0.40	0.45	0.50	0.55	0.60	0.65	0.70	0.75	0.80
Max. system drop	cm	400	400	400	400	400	400	400	400	400	380	350	330	300	280

To obtain fabric thickness information for a specific Silent Gliss fabric, please refer to the Silent Gliss fabric binder or contact Silent Gliss.



4960

System Options

Double (connected) systems with centre support brackets 10626 (only possible with 230V motors)

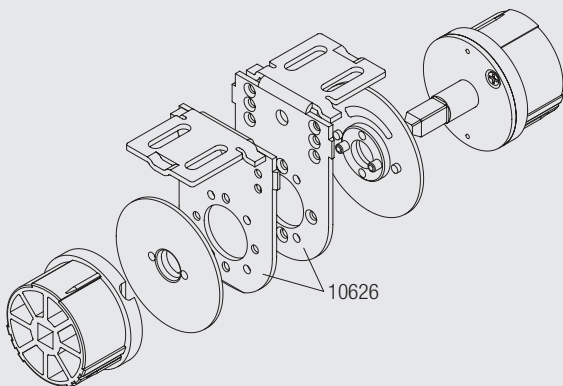

The optional centre support bracket allows two connected systems to be powered by one motor. It can also be combined with continuous installation profile for easy on-site fixing.

Side-by-side systems (unconnected)

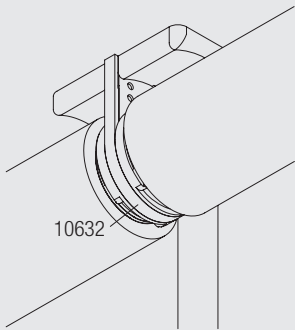

10632 Intermediate cover

Side guides for stabilising blind systems and sloped applications (up to 15° incline)

Single system

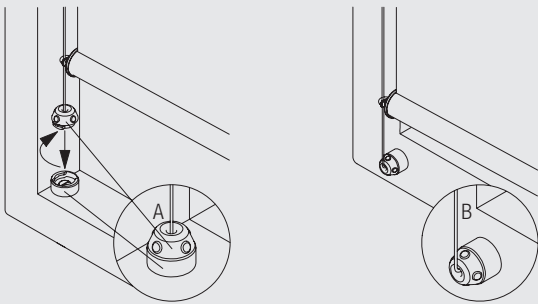

Double system

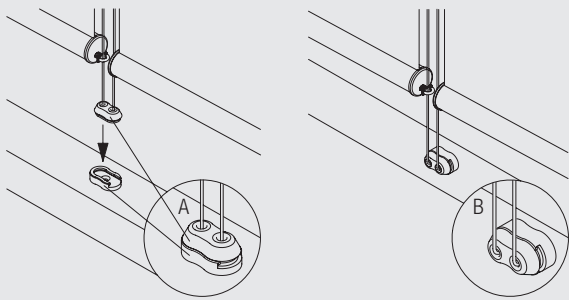

A: Fitting of side guides inside window frame
B: Fitting of side guides to front of window frame



4960

Optional box fascia

System 4960 is available with an optional box fascia. Please contact Silent Gliss for further details.

Fitting Information

Positioning of system

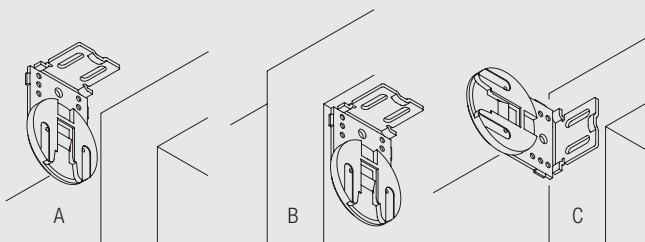

A: Ceiling Fixing
B: Recess Fixing
C: Wall Fixing

Easy loading and removal of the blind

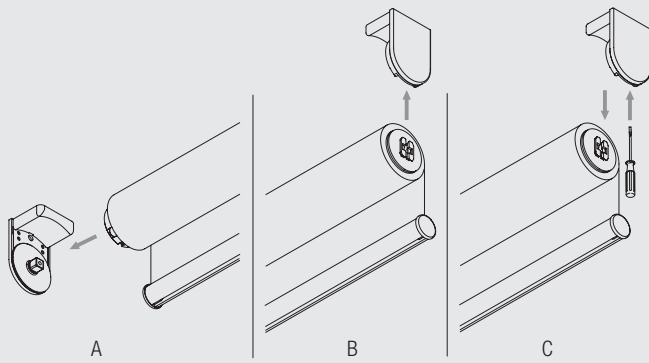

- A: Insert roller blind into support bracket (drive side)
- B: Click roller blind into support bracket (click side)
- C: Use small screwdriver to remove roller blind

Alternative fixing with continuous installation profile (optional)

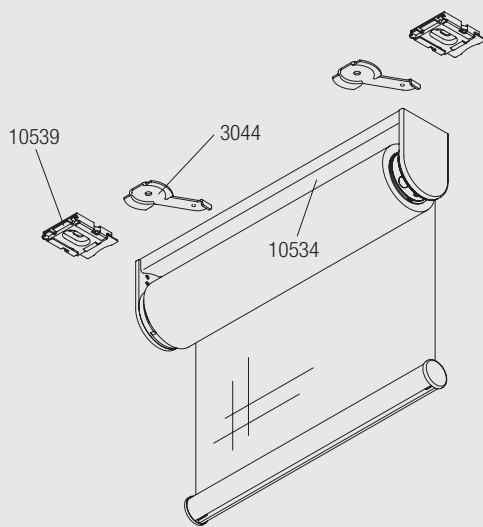

System is pre-mounted on continuous installation profile 10534 for fast fitting on site. Just mount the system with pre-fixed clamps 3044 or click brackets 10539.

Please note: click brackets 10539 cannot be used with double (connected) systems.



4960

Fitting Options

CAD download available from www.silentgliss.co.uk (password required)

Ceiling fix with brackets

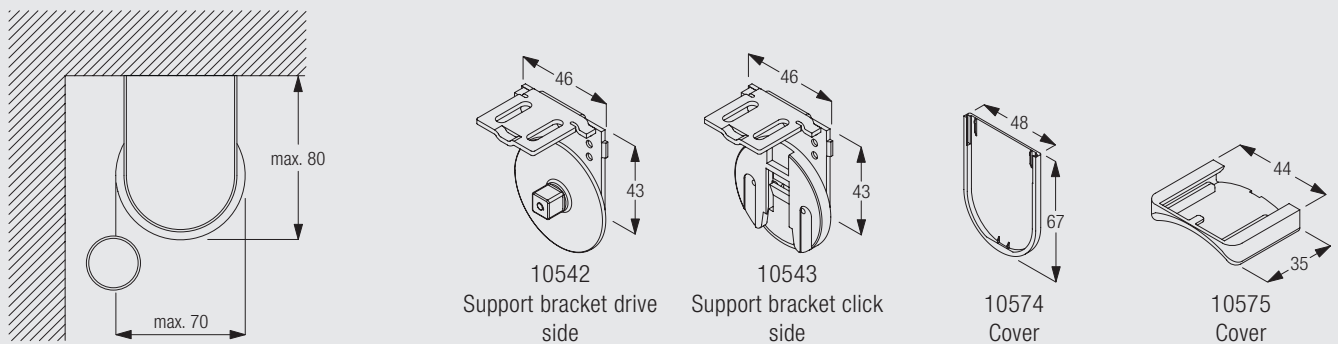

All measurements are based on the maximum system dimensions.

Ceiling fix with optional installation profile and clamps 3044

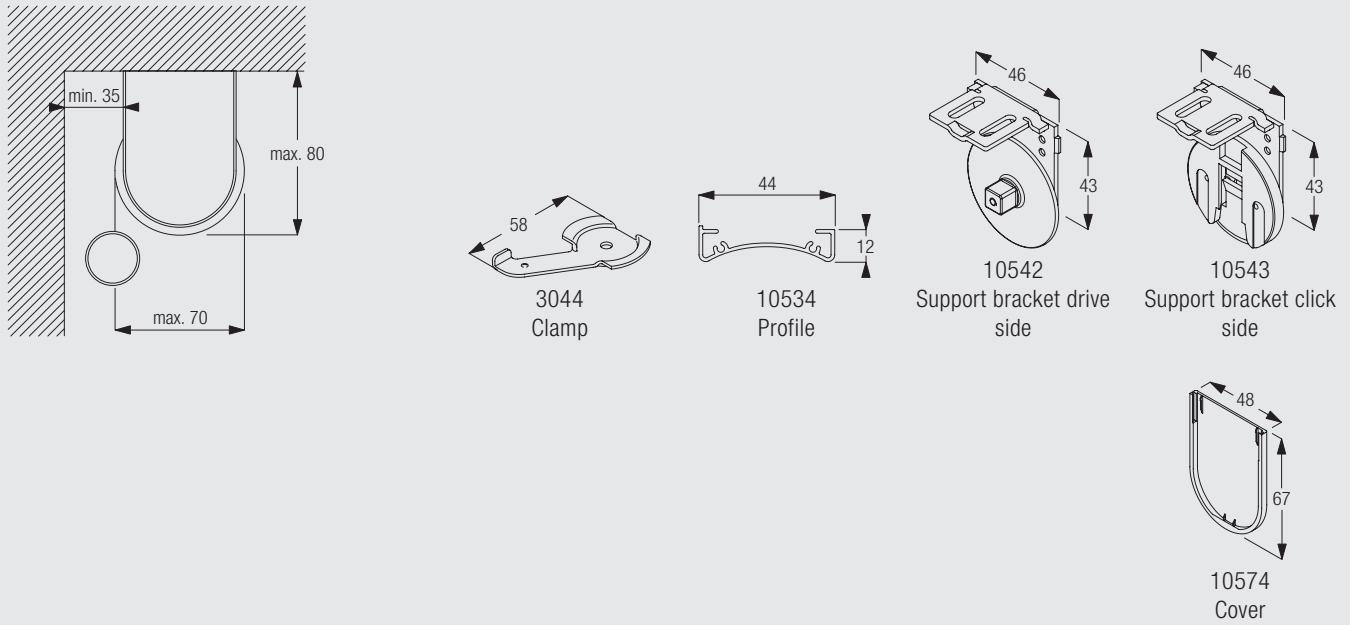

All measurements are based on the maximum system dimensions.

Ceiling fix with optional installation profile and click bracket 10539

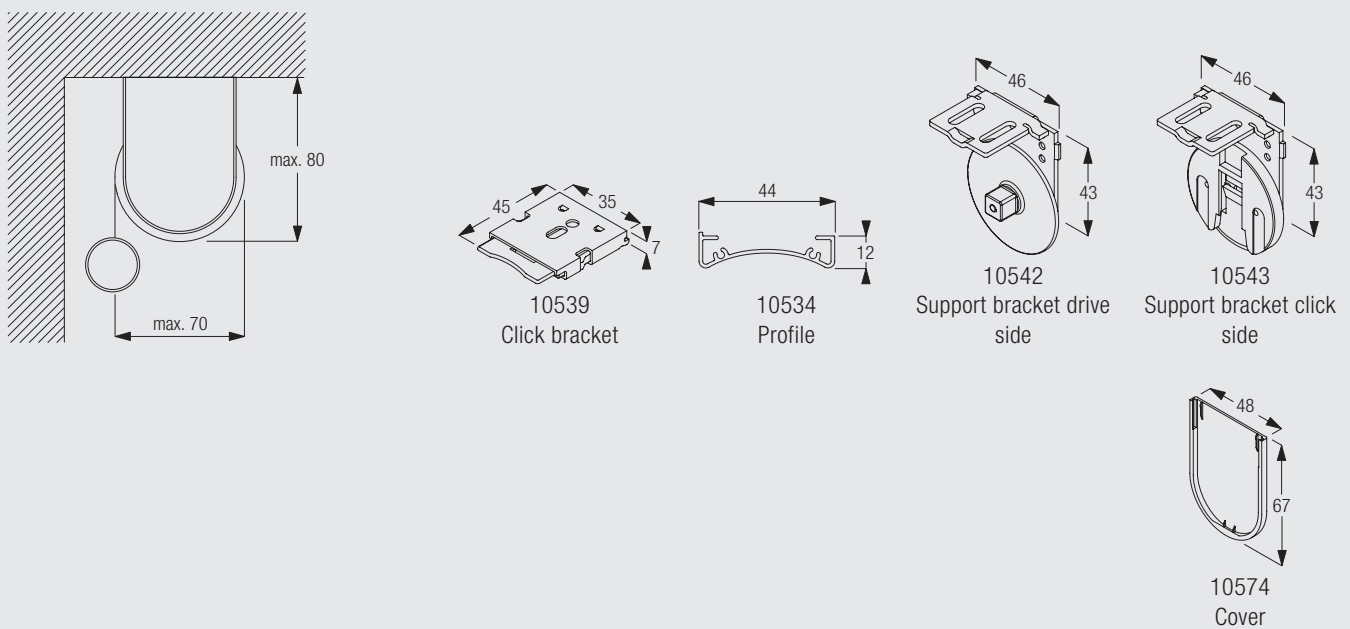

All measurements are based on the maximum system dimensions.

Please note: this fitting option is not possible with double (connected) systems.

Wall fix with brackets

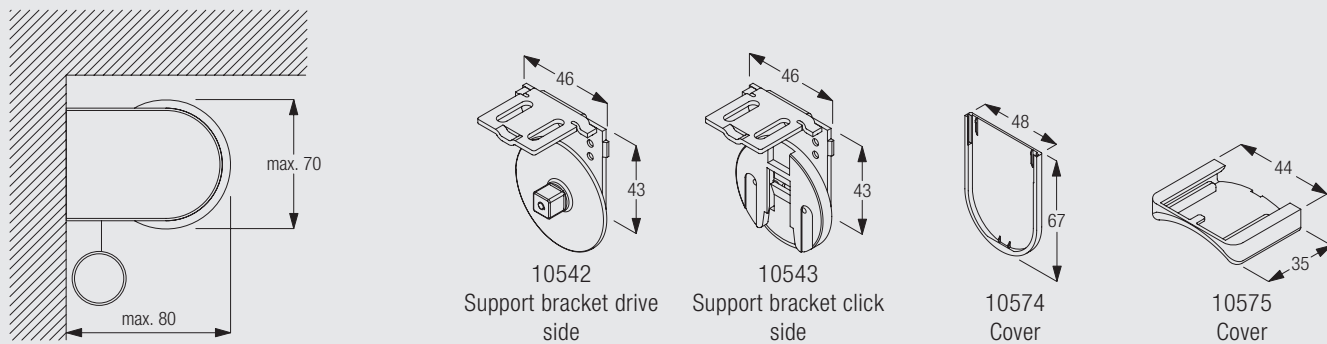

All measurements are based on the maximum system dimensions.

Wall fix with optional installation profile and clamps 3044

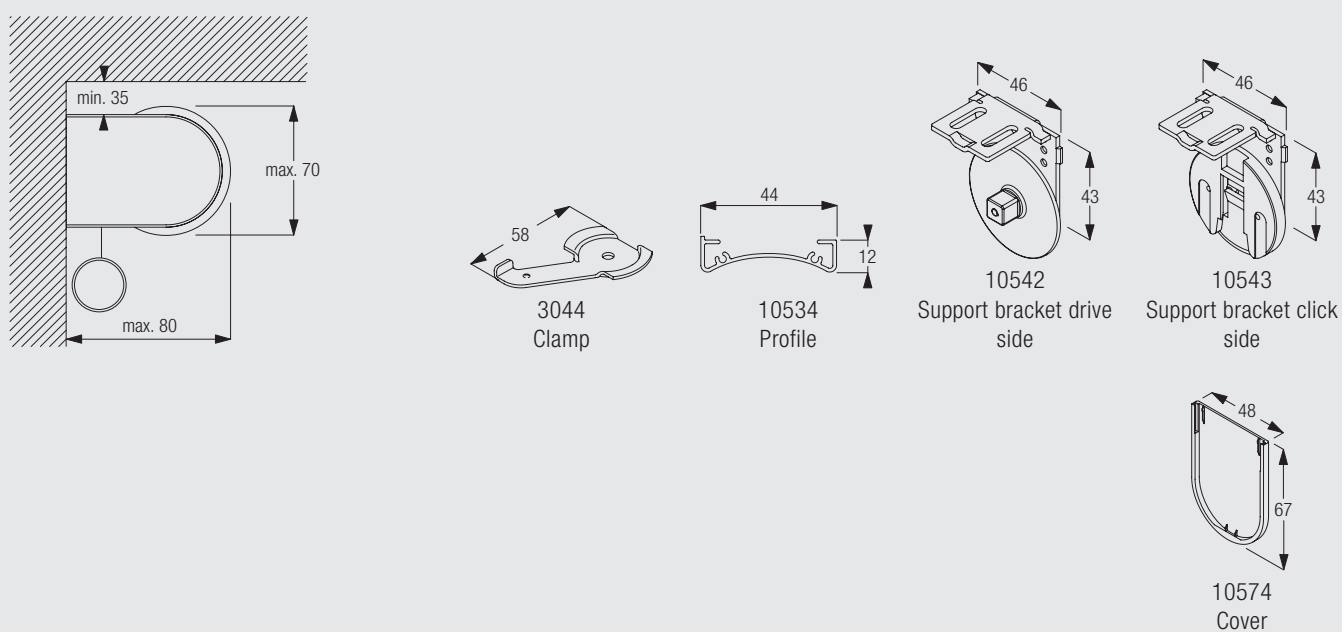

All measurements are based on the maximum system dimensions.

Wall fix with optional installation profile and click bracket 10539

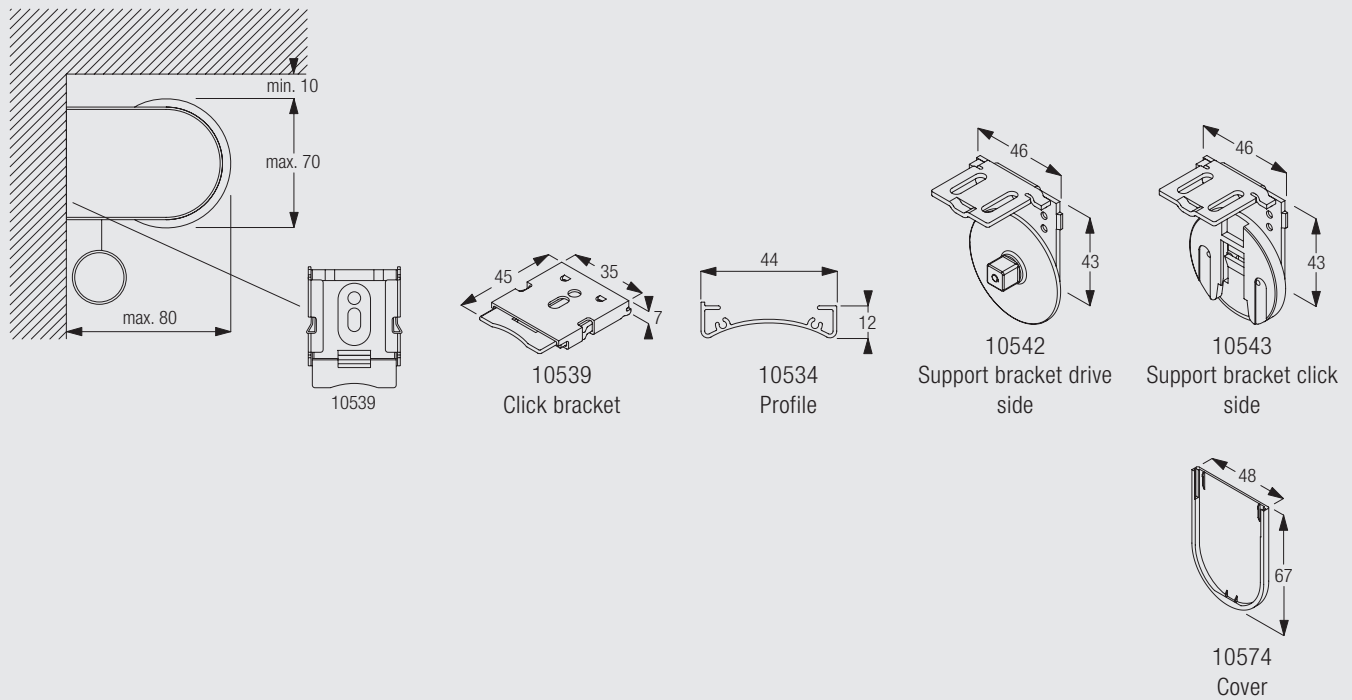

All measurements are based on the maximum system dimensions.

Please note: this fitting option is not possible with double (connected) systems.

Recess fix with brackets

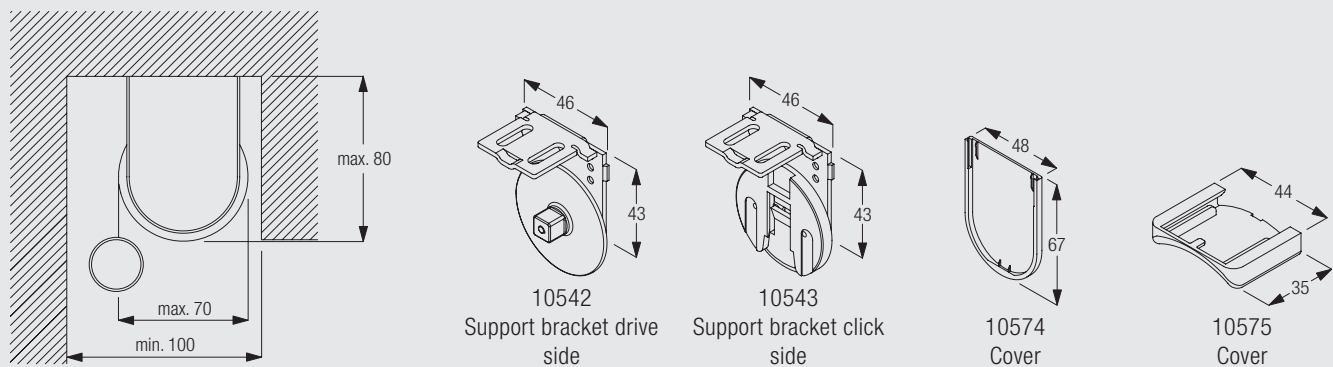

All measurements are based on the maximum system dimensions.

Recess fix with optional installation profile and clamps 3044

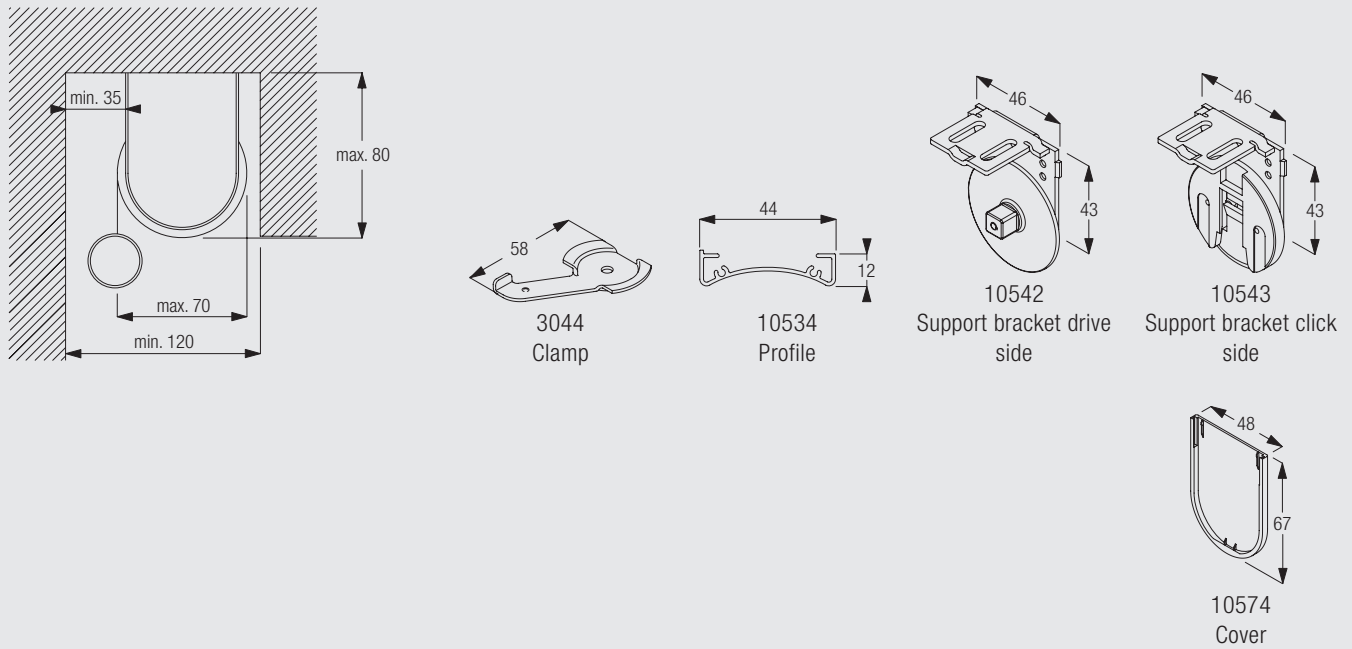

All measurements are based on the maximum system dimensions.

Recess fix with optional installation profile and click bracket 10539

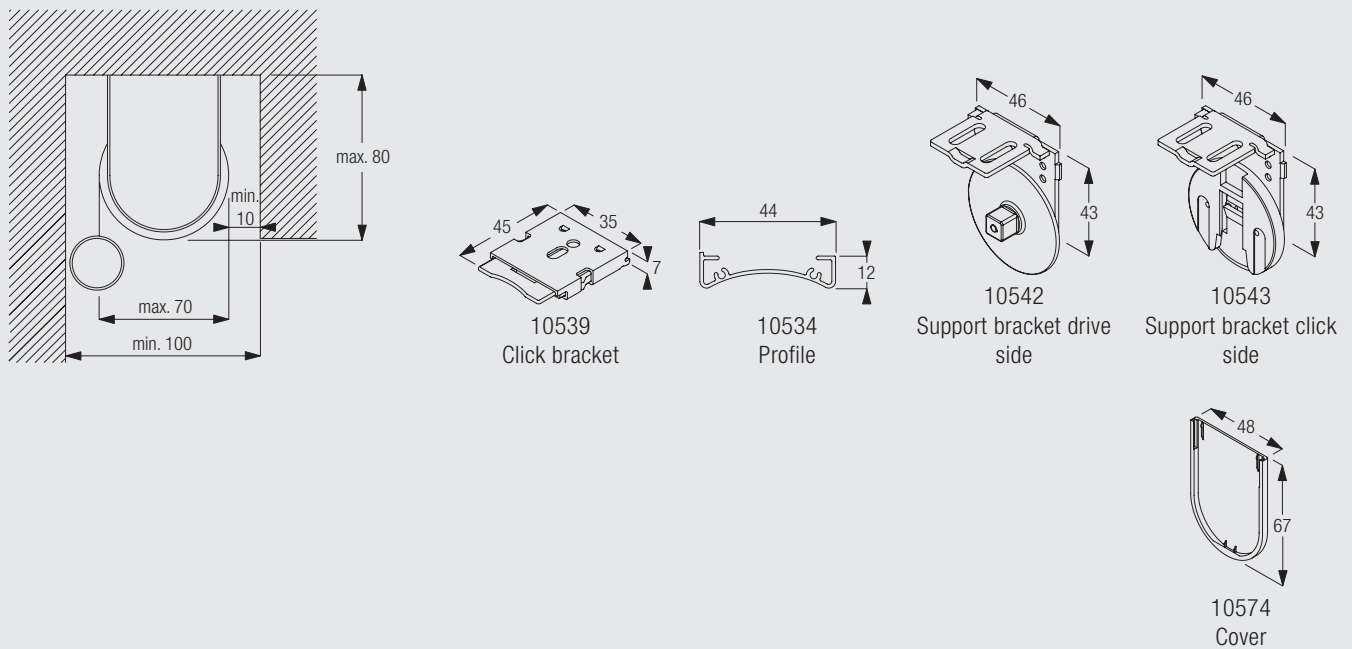

All measurements are based on the maximum system dimensions.

Please note: this fitting option is not possible with double (connected) systems.

Fitting with side guide option

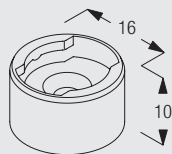
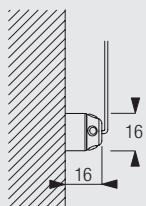
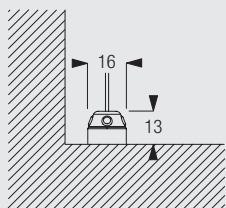

8236
Wire base long

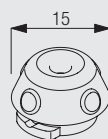

8237
Wire holder

Fitting with side guide option (connected and side-by-side installations)

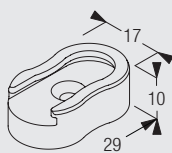
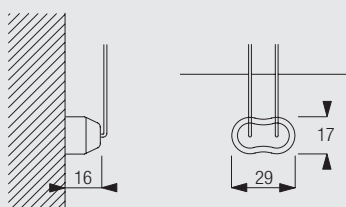
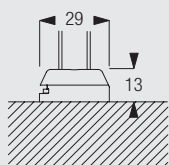

10669
Double base long
(side guide)

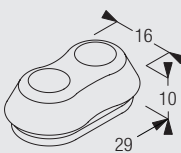

10701
Double wire holder
(side guide)



4960

Standard Accessories

10320 Motor 20-Series, 230V



10542 Support bracket drive side



10574 Cover



10639 End cover round



4221 Bottom bar



10532 Profile



10543 Support bracket click side



10575 Cover

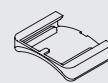







Optional Accessories

0578 Pattress box



0615 Latching switch inc. pattress box

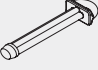

0997	Motor Test Lead		3044	Clamp	
8235	Wire base short		8236	Wire base long	
8237	Wire holder		8249	Locking ring	
10321	Motor 20-Series, 230V, radio receiver		10387	Cover for metal bracket	
10534	Profile		10535	Design end cover round (metal)	
10539	Click bracket		10544	Support bracket drive side (24V DC motor)	
10626	Intermediate bracket stainless steel		10627	Intermediate flange	
10628	Adapter for intermediate connector		10632	Intermediate cover	
10633	Bottom bar rectangle		10634	Bottom bar oval	
10635	End cover rectangle		10636	End cover rectangle (side guide)	
10637	End cover oval		10638	End cover oval (side guide)	
10640	End cover round (side guide)		10641	Eyelet (side guide)	
10642	Wire holder (side guide)		10643	Wire \varnothing 1.3mm x 4.2m (side guide)	
10651	Intermediate flange with ring		10669	Double base long (side guide)	
10673	Double base short (side guide)		10701	Double wire holder (side guide)	
10703	Design bracket click side		10704	Design bracket drive side	
10705	Design bracket drive side (24V DC motor)		10706	Wire \varnothing 1.3mm x 2.6m (side guide)	

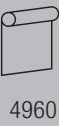

4960

Useful Measurements

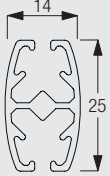
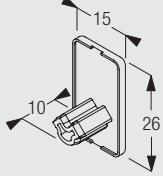
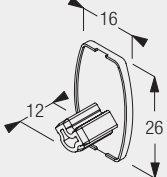
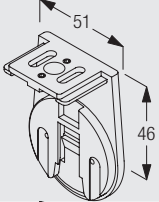
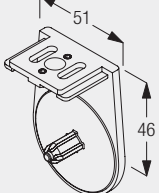
4221	Bottom bar		10633	Bottom bar rectangle	
10634	Bottom bar oval		10635	End cover rectangle	
10637	End cover oval		10639	End cover round	
10703	Design bracket click side		10704	Design bracket drive side	
10705	Design bracket drive side (24V DC motor)				



4960

Overview Motors & Controls

Motor and Control Features	Motor
	10320, 10321

Motor Features

Electronic end-stop programming with Silent Gliss transmitters or motor test lead	●
Electronic revolution counter (unlimited revolution)	●
Two intermediate positions possible (only applicable with built-in motor receiver)	●
Exact programming of intermediate positions possible	●
Parallel wiring possible without additional relays	●
Parallel wiring possible without additional relays with built-in motor receiver	●
Soft stop	●
Cable connectable with plug into motor and available in different lengths	●

Control Features

Silent Gliss Radio Remote Control System 9940 (only applicable with built-in motor receiver)	●
Silent Gliss Radio Remote Control System 0450 (external receiver necessary)	●
Suitable for all common home automation and bus systems	●

Motors Silent Gliss 10320 / 10321 (230V)

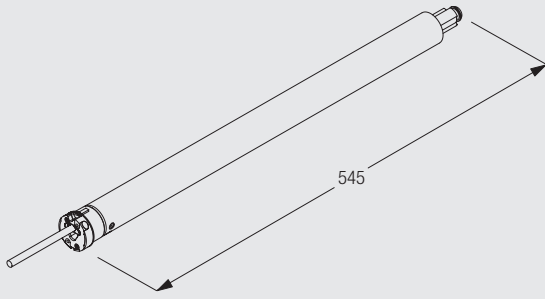

- Voltage: 230V
- Frequency of receiver of Motors 10321: 915MHz
- Torque: 1.5Nm
- Speed: 70rpm
- Frequency: 50Hz
- Power: 135W
- Current: 0.60A
- Thermal overload protection
- CE Standard
- Cable pluggable

Operating Methods

Operation via fixed switch with motor 10320

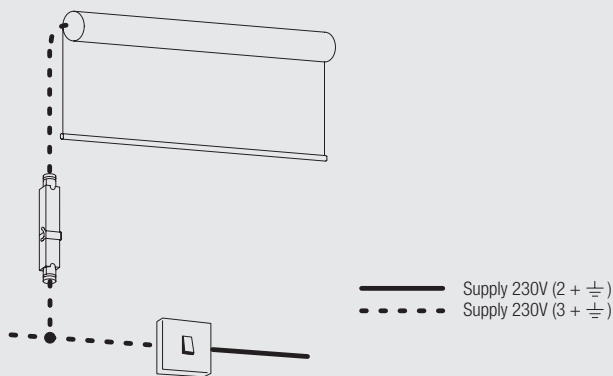

Up to 10 motors can be wired in parallel, cumulative total load to be 25% below the switch/fuse rating.

When using the fixed switch control for multiple blinds, when operating the blinds simultaneously the blinds may not necessarily stop at precisely the same intermediate point. Top and bottom levels can be preset in alignment.

If this is a requirement then we recommend using Radio Remote Control System 0450 with individual and simultaneous switching.

Operation with Radio Remote Control System 9940 or 0450

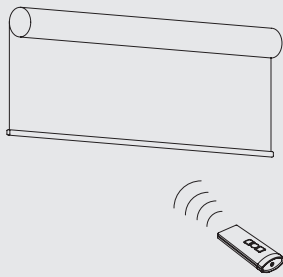

4960

System 4960 can be combined with Radio Remote Control System Silent Gliss 9940 using motor 10321 (integrated receiver) or Radio Remote Control system 0450 using motor 10320 (non integrated receiver) with minimum wiring. For further details, please refer to catalogue section "Motors & Controls".

Important: Wiring diagrams are available on the Silent Gliss website (password required) www.silentgliss.co.uk.

Motor Silent Gliss 24V DC (optional motor for volt free contact switching)

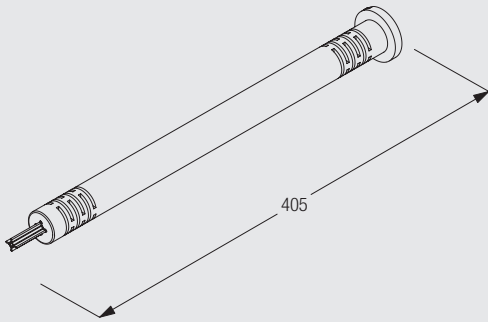

- Voltage: 24V DC
- Torque: 2Nm
- Speed: 28rpm
- Current: 0.75A

Operating Methods

Operation via fixed switch with motor 4960LV

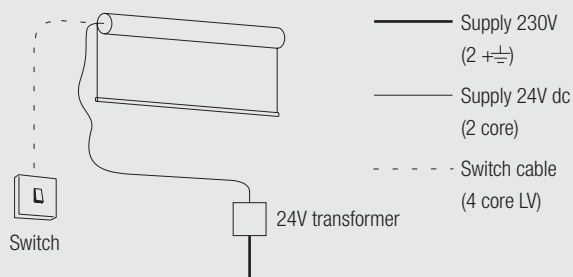

Individual operation by volt free contact switch.

Wiring and connections

Important: Wiring diagrams are available on the Silent Gliss website (www.silentgliss.co.uk).

Note: For system integration with external controls please contact Silent Gliss for details.



4960



4960



4960



4960

www.silentgliss.co.uk

www.silentglissglobal.com

Silent Gliss Ltd
Pyramid Business Park
Poorhole Lane
Broadstairs
Kent
CT10 2PT
Great Britain

Tel: +44 (0) 1843 863571
Fax: +44 (0) 1843 864503
info@silentgliss.co.uk

Silent Gliss Global Ltd
Pyramid Business Park
Poorhole Lane
Broadstairs
Kent
CT10 2PT
Great Britain

Tel: +44 (0) 1843 874250
Fax: +44 (0) 1843 874457
info@silentglissglobal.com